



# Do-It-Right : EASE (Private) in Conserved Buildings

A Guide for Installation of Improvement Items to Conserved Buildings under the Enhancement for Active Seniors (EASE) (Private Housing) Programme

April 2026

# Contents

<b>1</b>	<b>Why This Guide?</b>	1
<b>2</b>	<b>Types of EASE Improvement Installations</b>	3
<b>3</b>	<b>Installation Guide</b>	5
	Typical Residential Front (No Decorative Elements)	6
	Residential Front with Historic Fixtures	7
	Residential Front with Historic Features	8
	Residential Front with Special Finishes	9
	Special Interior Finishes	10
<b>4</b>	<b>Installation Procedure</b>	12
	Is Submission Required?	13
<b>5</b>	<b>Useful Links</b>	14
<b>6</b>	<b>Contact Us</b>	17

# 1. Why this guide?

As owners of conserved buildings, you are custodians of an asset with historical, architectural, socio-cultural, and economic value for the nation. Adapting these properties to meet changing accessibility needs careful consideration to protect their heritage character while ensuring safety and comfort.

This guide is to **help homeowners navigate the process of installing accessibility features in their conserved properties** under the **EASE (Private) programme**. It focuses on common fixtures such as grab bars, handrails and ramps, detailing how these can be integrated sensitively within your home's existing architecture.

The guide shows typical installation scenarios, and highlights key principles and considerations to observe. For complex situations or when in doubt about specific installations, you should always seek professional advice or contact the URA Conservation Department at [ura\\_cu@ura.gov.sg](mailto:ura_cu@ura.gov.sg).

## About EASE (Private)

The Enhancement for Active Seniors (EASE) (Private Housing), or EASE (Private) programme, which supports the Age Well SG initiative, is a national programme designed to improve the physical living environment and support active ageing. The programme provides subsidies for installing senior-friendly fittings in private properties (including conserved properties) for eligible households with Singaporean Citizen seniors, enabling seniors to age-in-place comfortably. More information on the EASE (Private) programme can be found at <https://go.gov.sg/ease-private>

## 2. Common EASE Improvement Installations Requiring Special Considerations

1. Grab bars (linear, fixed U-profile, or foldable U-profile)



2. Handrail (usually installed at main entrances with steps)



3. Single-step ramp at main entrance (ramp to be removed after use)





# 3. Installation Guide

Conservation Guidelines

## a. Typical Residential Front (No Decorative Elements)

### Allowable Locations for Installations

Where there is no decorative elements at the residential front (e.g. pintu pagar, dado tiles)



Residential Front with No Decorative Elements

 Installation of grab bars on plain plaster surface - **Allowed**

 Ramp anchor installation (on kerb) – **Allowed**



## b. Residential Front with Historic Fixtures

### Allowable Locations for Installations

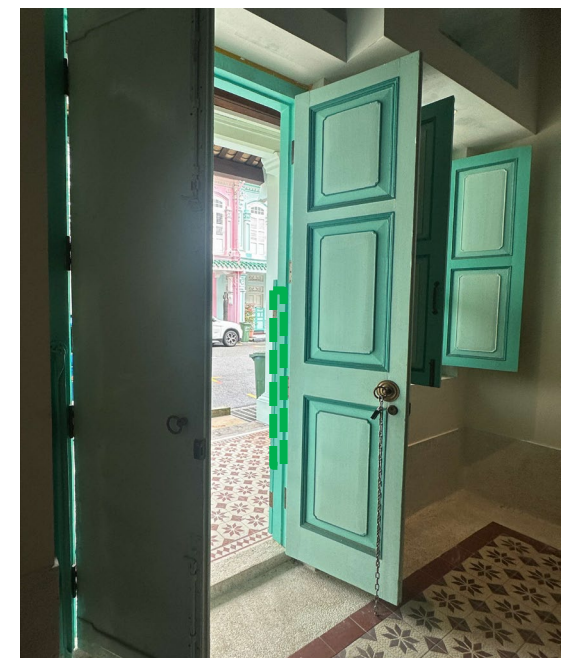
Where there are historic features (e.g. pintu pagar) on the residential front of the conserved buildings, alternative locations for installations (e.g. on door frame) should be considered.



Residential front with pintu pagar

-  Installation of grab bar between pintu pagar and door frame (subject to sufficient space) – **Allowed**
-  Installation of ramp at main entrance step (anchored by bolt on the step) – **Allowed**
-  Installation of grab bars affecting outward swing of pintu pagar – **Not allowed**

## c. Residential Front with Historic Features

### Allowable Locations for Installations

Where there are historic features at the entrance of the conserved building (e.g. textured plaster forecourt wall, moulded panel gatepost etc), alternative locations for installation (e.g. on walls with plain plaster) should be considered.



Forecourt wall with moulded panel gateposts



Forecourt wall with textured plaster finish



Installation of grab bars on plain plaster surface - **Allowed**



Installation of grab bars on historic features with special finish – **Not allowed**

## d. Residential Front with Special Finishes

### Allowable Locations for Installations

Where there are special finishes on the residential front (e.g. textured or ornamental plaster, exposed bricks, etc), alternative locations for installation (e.g. on adjacent walls with plain plaster) should be considered.



Textured plaster



Textured plaster

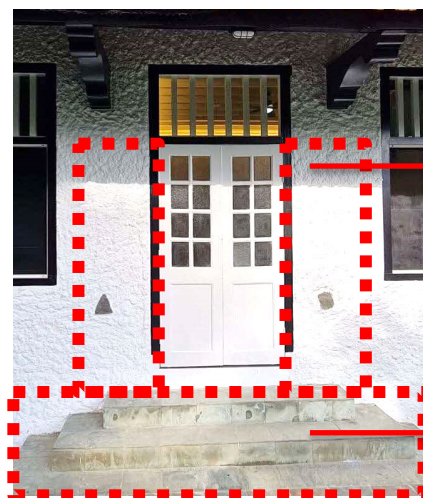

Granite steps



Installation of grab bars or railings on flat plain plaster – **Allowed**



Installation of grab bars or railings on special finish – **Not allowed**

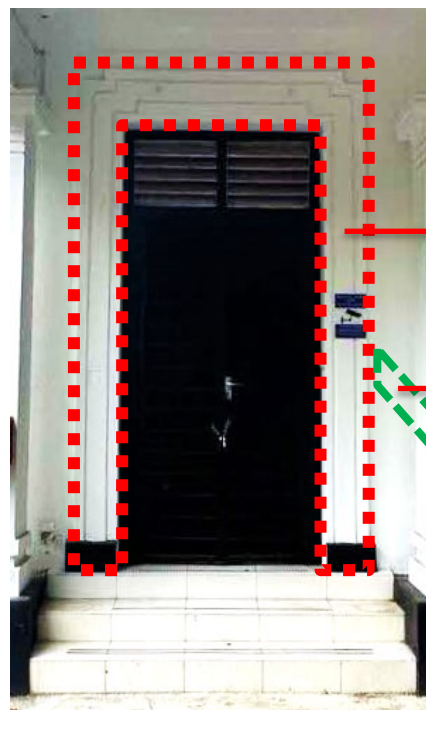

Decorative plaster architrave

Railing anchored on plain plaster wall

## d. Residential Front with Special Finishes

### Allowable Locations for Installations

Where there are special finishes on the five-foot way in front of the residential front (e.g. encaustic floor tiles, terracotta tiles, etc), any installation should not be drilled down directly on the finishes.



Terracotta tiles



Encaustic tiles

 Ramp anchor installation (on kerb) – **Allowed**

 Note: Any ramp installation can cover the decorative tiles but should not be drilled down

#### Installation of single-step ramp

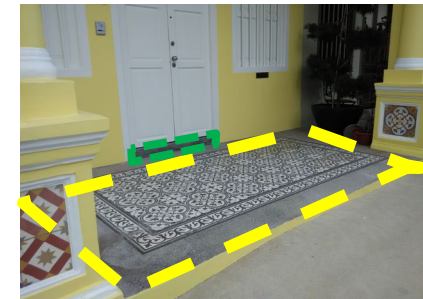

Anchor bolts are to be installed on the kerb for the removable ramp and not directly onto the floor finish. When not in use, the ramp should be kept.

## e. Special Interior Finishes

### Allowable Locations for Installations

Where there are special features on the interior walls/partitions (e.g. timber panelling, dado tiles, plaster ornaments etc), alternative locations for installation (e.g. on adjacent walls with plain plaster) should be considered.

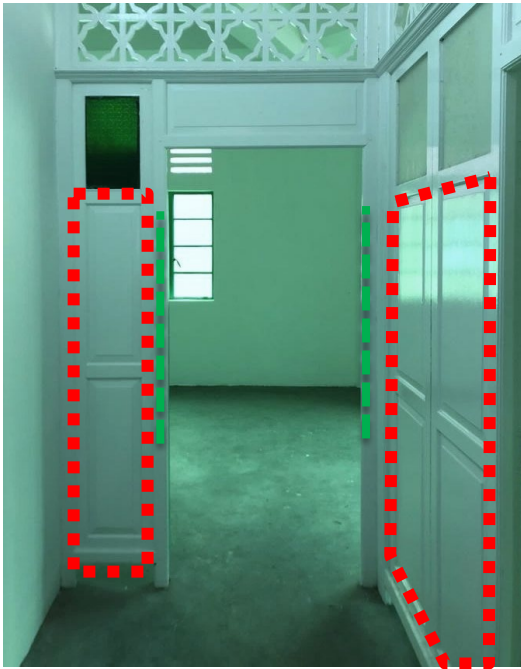

Timber Panelling



Dado Tiles



Plaster ornaments

 Installation of grab bars on flat timber or plain plaster surface - **Allowed**

 Installation of grab bars on special interior finish – **Not allowed**



# 4. Installation Procedure

Requirement for submission under Category 3 Works

## Is submission required?

### What should I do if I wish to opt for the EASE fittings?

1. Make an assessment to identify any historic/special features that may be affected. Refer to guidelines on pages 6 to 11 before installation.
2. Work around historic finishes without damaging them. Do not proceed with installation if unsure, or if technically not feasible.

### What should I do if I am unsure on where I can install the EASE fittings?

1. Refer to pages 6 to 11 of the guidelines. If still unsure, submit and obtain URA's clearance through our e-Services.
2. Install the fittings only after approval has been issued.

### What happens if there is no approval for my fittings?

You will be required to remove them and make necessary repairs **if they cover/cause damage to key architectural or decorative features.**

#### Submission Procedures

A submission to URA is to be made online via: [URA e-Services](#) (Apply for Category 3 Works for Conserved Buildings)



All QR codes of links indexed on Page 14

## 5. Useful Links

### Conservation Guidelines

<https://go.gov.sg/conservationguidelines>

Access the full list of planning parameters and guidelines for conserved buildings.

### Additions & Alterations

<https://go.gov.sg/conservationadditionalterations>

Find out more about the application process for making additions and alterations to conserved buildings.

### Signage Guidelines

<https://go.gov.sg/conservationsignageguidelines>

Access the full list of Signage Guidelines and learn more about how you can apply for Conservation Permission for Signages on your conserved building.



## 5. Useful Links

### **Emerald Hill Traditional Paint Scheme Guidelines**

<https://go.gov.sg/emeraldhillpaintscheme>

Find out more about the paint scheme guidelines and process for conserved buildings at Emerald Hill Conservation Area.



### **Approved Uses**

<https://go.gov.sg/approveduse-shophouses>

Check the allowable and the last approved uses for all private shophouses & selected properties in Singapore.



### **Definition of URA Use Classes**

<https://go.gov.sg/urauseclass>

Find out more about the legal definitions for each type of use under the URA Use Class framework



## 5. Useful Links

### **Conservation e-Services**

<https://go.gov.sg/conservation-services>

Access the full list of e-Services from applications for Category 3 works for Conserved Buildings to requests for Specific Restoration Guidelines.



### **Architectural Heritage Awards**

<https://go.gov.sg/ahasg>

Access the list of past Architectural Heritage Award winners and their portfolios for reference.



## 6. Contact Us

**For enquiries and feedback on this guide,  
please contact us at :**

[www.ura.gov.sg/Corporate/Contact-Us](http://www.ura.gov.sg/Corporate/Contact-Us)

Address:

Conservation Department  
45 Maxwell Road, The URA Centre  
Singapore 069118



View this guide online:

<https://go.gov.sg/conservationbestpractices>



For more information on conservation areas and  
conserved buildings:

<https://go.gov.sg/uraconsportal>



To make Singapore a great city to live, work and play

[www.ura.gov.sg](http://www.ura.gov.sg)

© Urban Redevelopment Authority

Version 1, April 2026